



PRODUCT CATALOG

Part No: IN-200CA

Date: 08/31/2023

CONTENTS

3 Introduction

- 3 About This Catalog
- 3 Where to Order
- 4 Bracket Versions

5 Halo

- 5 Halo System Components
- 5 Halos
- 6 Hoses
- 7 Brackets
- 8 FlowBelow
- 8 Accessories/Replacement Parts
- 8 Instructions
- 9 Service Kits and Tool Kits
- 9 Fastener Replacement Kits

10 Halo Connect

- 10 Halo Connect Components
- 11 Halo Connect Kits
- 11 Tools and Hardware
- 12 Power Harnesses
- 13 TPMS Sensors
- 14 Replacement Parts
- 14 Compatibility Chart

15 Halo and parts compatible with 1st generation brackets

- 15 Halos
- 16 1st Generation Brackets
- 17 FlowBelow
- 17 Service Kits and Tool Kits
- 18 Replacement Parts

ABOUT THIS CATALOG

This catalog contains parts, tools, service kits for the Halo Tire Inflator and Halo Connect. There are two sections for the Halo to cover parts, tools and service kits for the Halo with 1st generation brackets (model #s HA-3, HA-2, HA-1) and the latest version of the Halo (model #s HA-4 and beyond). Please see the table on the next page to determine which Halo section to reference.

WHERE TO ORDER

Replacement parts are available on our website.

aperiatech.com/shop

SUPPORT

We'd be happy to answer your questions about ordering the Halo or replacement parts. Call the number below and select (1) for sales or email us. We look forward to hearing from you.

Phone

+1-844-RUN-HALO

Website

www.aperiatech.com

Sales

sales@aperiatech.com

INTRODUCTION

BRACKET VERSIONS

The table below helps in identifying if you have the Halo with first generation brackets or the current Halo design. Be sure to reference the section of the catalog that applies to your version of the product. Note that the hoses are compatible with both versions.

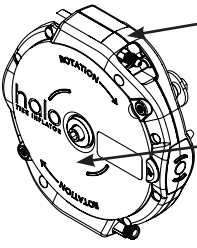
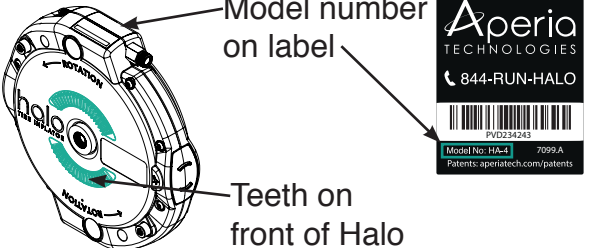
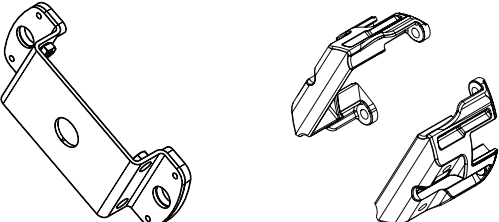
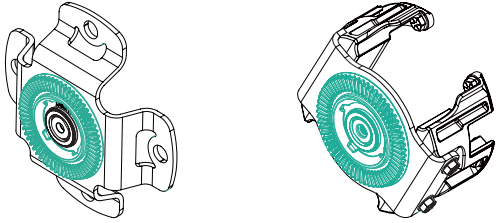
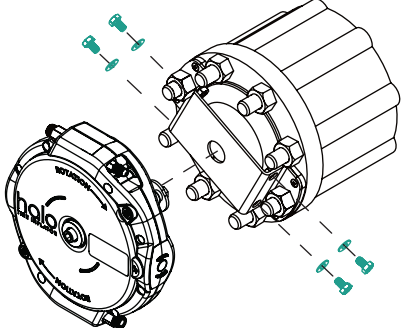
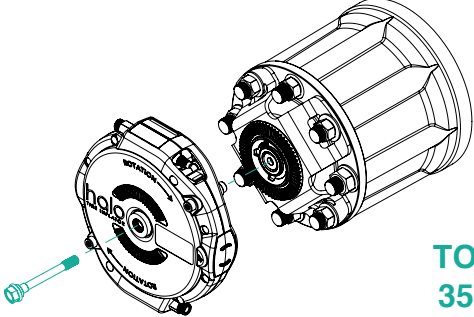
	HALO W/ 1ST GEN. BRACKETS	HALO
Halo	 <p>Model number not present on label</p> <p>No teeth on front of Halo</p> <p>Part #s beginning with HA-1, HA-2, HA-3</p>	 <p>Model number on label</p> <p>Teeth on front of Halo</p> <p>Part #s beginning with HA-4 and above</p>
Brackets	 <p>Part #s beginning with BR-4 and BR-8</p>	 <p>Part #s beginning with BR-D</p>
Mounting Method	 <p>TORQUE: 20 FT-LB</p> <p>Each Halo is configured for either the left or right side of the vehicle.</p>	 <p>TORQUE: 35 FT-LB</p> <p>Each Halo can be used on left or right side of vehicle.</p>
Hoses	BOTH HALO VERSIONS ARE COMPATIBLE WITH APERIA HOSES.	

HALO SYSTEM COMPONENTS:

TRACTOR AXLE (R TYPE)

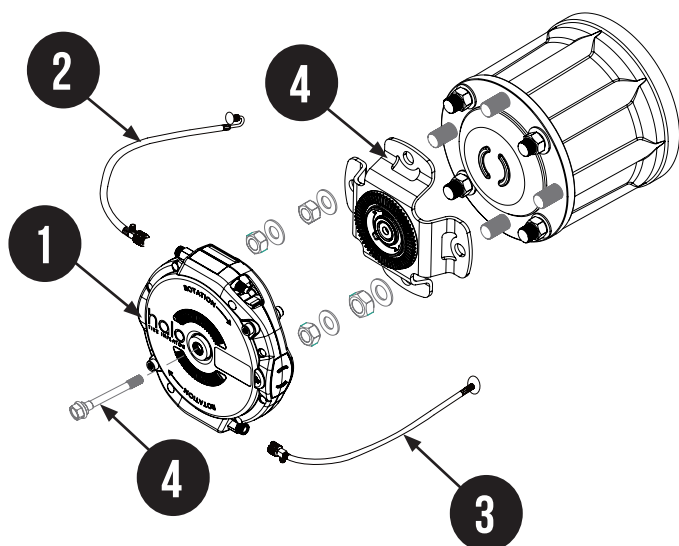

TRAILER AXLE (P OR N TYPE)

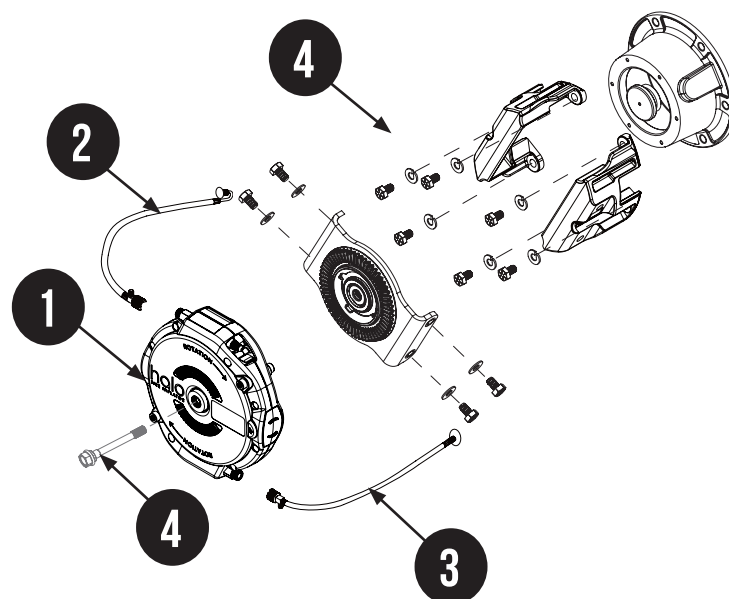

One component is required for a complete wheel-end installation. Bracket kits and hose kits vary based on vehicle configuration.

1. Halo Tire Inflator™
2. Hose - Outer Dual Tire (wide-base conversion cap is used for single tires)
3. Hose - Inner Dual Tire
4. Bracket Kit (includes fasteners)

HALO TIRE INFLATOR™

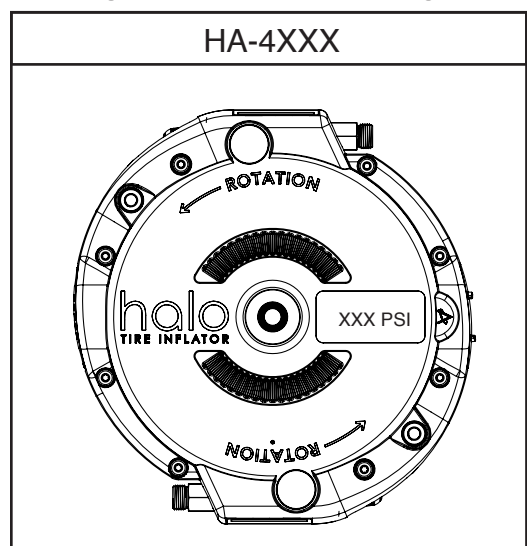

Part Number	Target Tire Pressure
HA-4080H	80 PSI
HA-4085H	85 PSI
HA-4090H	90 PSI
HA-4095H	95 PSI
HA-4100H	100 PSI
HA-4105H	105 PSI
HA-4110H	110 PSI
HA-4115H	115 PSI
HA-4120H	120 PSI

HOSE KITS

STRAIGHT HOSES (typically inner dual)

Part Number	Description
HS-X080S	Straight Hose, 8 in.
HS-X100S	Straight Hose, 10 in.
HS-X110S	Straight Hose, 11 in.
HS-X120S	Straight Hose, 12 in.
HS-X130S	Straight Hose, 13 in.
HS-X140S	Straight Hose, 14 in.
HS-X145S	Straight Hose, 14.5 in.
HS-X150S	Straight Hose, 15 in.
HS-X160S	Straight Hose, 16 in.

WIDE-BASE HOSES*

Part Number	Description
HS-X080SW	Straight Hose, 8 in.
HS-X100SW	Wide-base Hose, 10 in.

180 DEGREE HOSES (Typically outer dual)

Part Number	Description
HS-X090U	180 degree Hose, 9 in.
HS-X100U	180 degree Hose, 10 in.
HS-X110U	180 degree Hose, 11 in.
HS-X120U	180 degree Hose, 12 in.
HS-X130U	180 degree Hose, 13 in.

Hose Seal Replacement Kits

Part Number	Description
TK-100HS	Tool Kit, Hose Seals
SK-124HG	Service Kit, Replacement, Hose Gasket (valve stem side)
SK-124OR	Service Kit, Replacement, Hose o-ring (Halo side)

*Wide-base hose lengths include plug (AC-100HS)

HOW TO MEASURE HOSES

Hose lengths are measured from crimp to crimp.

STRAIGHT HOSES

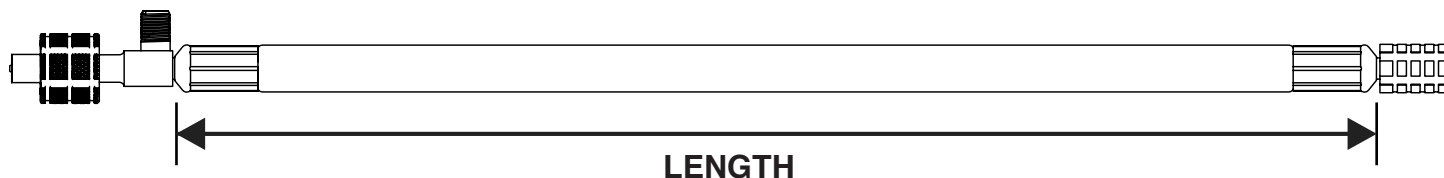

180 DEGREES HOSES

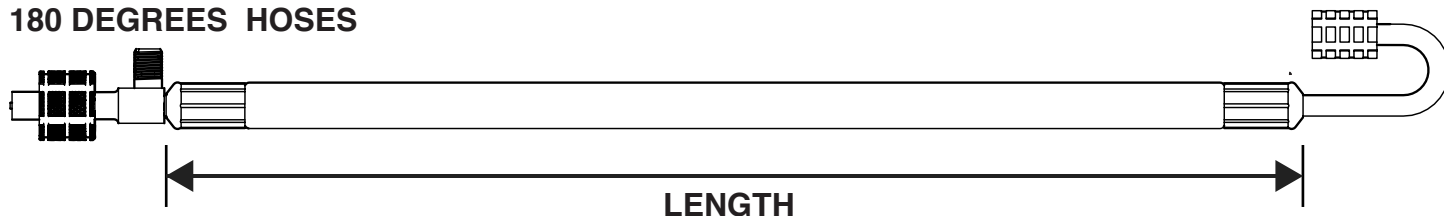

BRACKET KITS

Part Number	Tractor/Trailer	Description	Hub Stud/ Bolt Dia.	Stud/Bolt Circle Dia.	# of Studs/ Bolts
BR-DR58B	Tractor	Drive Axle	5/8 in.	7 in.	8
BR-DR58TB	Tractor	Tall for 6x2 tag/push	5/8 in.	7 in.	8
BR-DR34B	Tractor	Drive Axle	3/4 in.	7 in.	8
BR-DR58FA	Tractor	Drive Axle, w/o bolt	5/8 in.	7 in.	8
BR-DR58FTA	Tractor	Tall for 6x2 tag/push, w/o bolt	5/8 in.	7 in.	8
BR-DNB*	Trailer/Lift Axle	N-type Spindle	5/16 in.	5 1/2 in.	6
BR-DPB*	Trailer/Lift Axle	P-type Spindle	5/16 in.	6 3/4 in.	6

*Trailer/lift axle brackets ship with replacement hubcap bolts.(FA-200A)

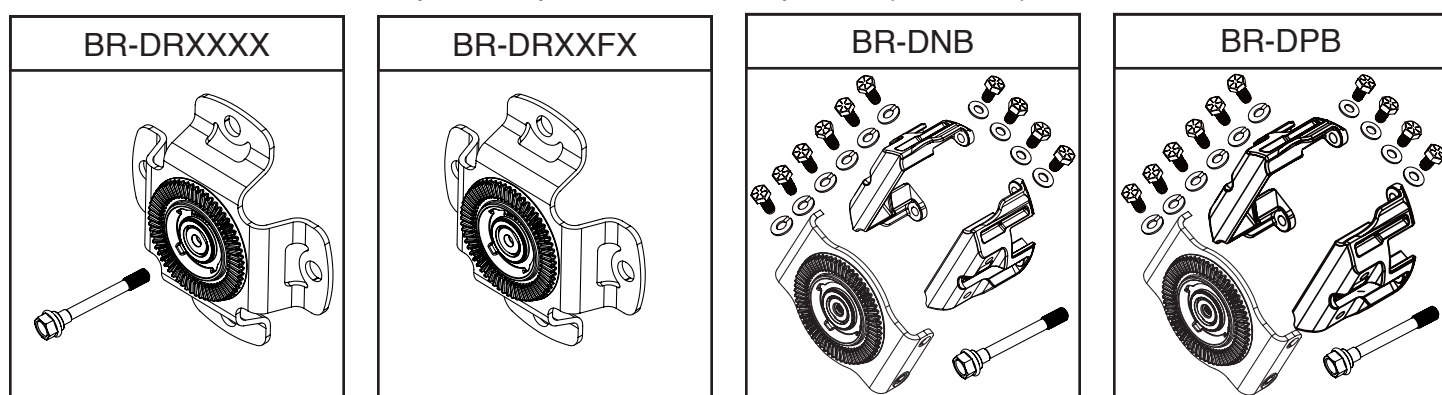

TRACTOR BRACKET COMPATIBILITY MEASUREMENTS

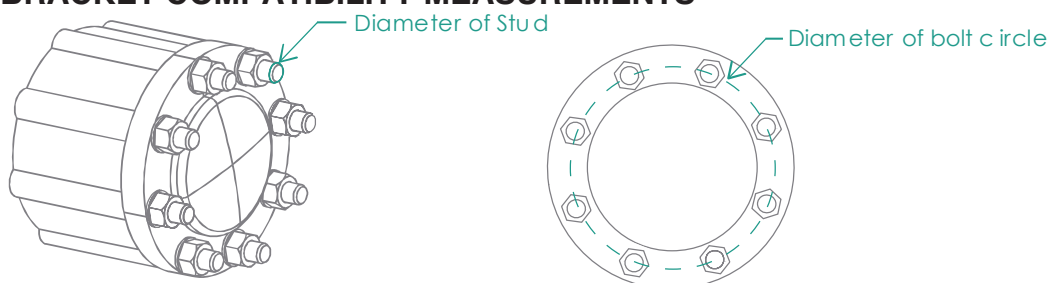

BRACKET-HUBCAP COMPATIBILITY CHART**

Bracket PN	Compatible Hubcaps		
BR-DNB 1st Gen. Bracket: BR-4009A	National 340-009	PAI AHS-9961	SKF 1644
	Stemco 343-4009	Stemco 340-5096	Stemco 340-5097
	Hendrickson HXL5 S-33376		
BR-DPB 1st Gen. Bracket: BR-4195A	ConMet 10018621	Dual Dynamics 7.5-GI	Dual Dynamics DG-7.5P
	PAI AHS-9907	Stemco 340-4195	Stemco 352-4195
	Hendrickson HXL5 S-33377		
BR-DR58TB BR-DR58FTA 1st Gen. Bracket: BR-8758TB	Stemco 340-4119 Incompatible with Sentinel version 356-4119 and with ESP plug		

**If your hubcap is not listed, please contact Technical Support.

FLOWBELOW PARTS

The Halo is compatible with FlowBelow wheel covers on trucks with either dual or wide-base tires. The Aperia sales team can help determine which parts you need to ensure a proper fit with your vehicle.

Part Number	Description
AC-400FB	FlowBelow to Halo Adaptor
AC-215FB	FlowBelow Standoff Kit, 1.5 in.
AC-220FB	FlowBelow Standoff Kit, 2.0 in.
BR-DR58FA	Tractor, Drive Axle, 5/8" Studs, no center bolt
BR-DR58FTA	Tractor, 5/8" Studs, Tall Bracket, no center bolt
FA-101FB	Fastener Kit, FlowBelow Mounting Nuts
FA-100FB	Fastener Kit, Replacement, FlowBelow Adaptor

ACCESSORIES/REPLACEMENT PARTS

Part Number	Description
AC-200CH	Halo Chrome Cover
AC-100HS	Conversion Cap, Dual Tires to Wide-base Tires
AC-402TR*	Tamper Resistant Kit, Single Axle, Truck
AC-404TR*	Tamper Resistant Kit, Single Axle, Truck
AC-412TR*	Tamper Resistant Kit, Single Axle, Trailer
AC-414TR*	Tamper Resistant Kit, Tandem Axle, Trailer
AC-100HR	Hose Retention Kit (Loctite 567 Thread Sealant)

AC-100HS

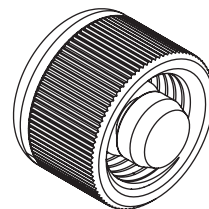

*Tamper resistant kits contain the fasteners and tool required for one vehicle.

INSTRUCTIONS & USER MANUALS

Part Number	Description
IN-202UM	User Manual, Halo Tire Inflator
IN-202RL	Roadside Service Instruction Label
IN-202UM-ES	User Manual, Halo Tire Inflator, Spanish
IN-202RL-ES	Roadside Service Instruction Label, Spanish
IN-202UM-FR	User Manual, Halo Tire Inflator, French
IN-202RL-FR	Roadside Service Instruction Label, French

SERVICE KITS & TOOL KITS

Service kits include the parts and consumable items required to return damaged Halos to working order. Tool kits contain tools that work best with the Halo.

Part Number	Description
TK-100HI	Tool Kit, Hose Install
TK-400CS	Tool Kit, Center Screw, FlowBelow
TK-400TR	Tool Kit, Center Screw, Tamper-Resistant
TK-200HF	Tool Kit, Round Hose Fittings
SK-200HF	Service Kit, Replacement, Round Hose Fittings
TK-100HS	Tool Kit, Hose Seals
SK-124HG	Service Kit, Replacement, Hose Gasket (valve stem side)
SK-124OR	Service Kit, Replacement, Hose o-ring (Halo side)

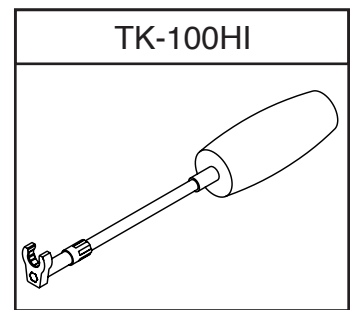

Speed up install and removal. Reach the hose at the valve stem.

FASTENER REPLACEMENT KITS

Aperia's fasteners have been designed to ensure proper strength and corrosion resistance. Be sure to replace any lost or damaged fasteners with fasteners provided by Aperia.

Part Number	Description	Included with
FA-400H	Fastener Kit, Replacement, Center Screw, Hex Screw	All Brackets
FA-100BR	Fastener Kit, Replacement, Halo Adaptor Plate to Bracket, 1 Halo	Trailer Brackets
FA-200A	Fastener Kit, Replacement, Trailer Bracket, Hubcap Bolts, 6 bolts	Trailer Brackets
FA-100FB	Fastener Kit, Replacement, FlowBelow Adaptor	AC-400FB
FA-100CH	Fastener Kit, Chrome Cover	AC-200CH
FA-402TR*	Tamper Resistant Fastener Kit, Single Axle, Truck	AC-402TR
FA-404TR*	Tamper Resistant Fastener Kit, Single Axle, Truck	AC-404TR
FA-412TR*	Tamper Resistant Fastener Kit, Single Axle, Trailer	AC-412TR
FA-414TR*	Tamper Resistant Fastener Kit, Tandem Axle, Trailer	AC-414TR

HALO CONNECT SYSTEM COMPONENTS

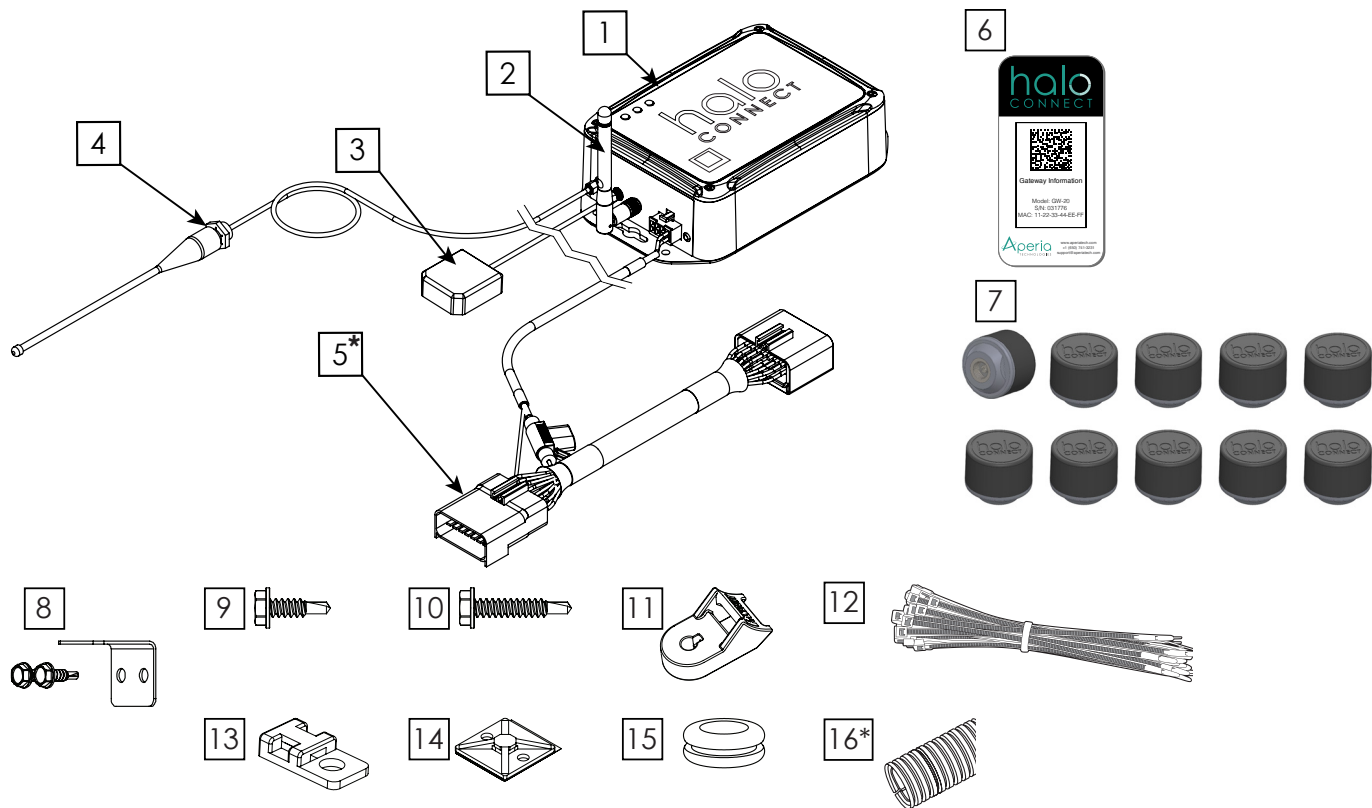

#	Qty	Description
1	1	Gateway
2	1	LTE antenna
3	1	GPS antenna
4	1	TPMS cable w/ antenna
5*	1	Power harness*
6	1	Gateway ID label
7	1	TPMS sensor kit (6-10 sensors)
8	1	TPMS antenna bracket w/ screws
9	9	5/8" long self tapping screws
10	8	1" long self tapping screws
11	2	Heavy duty cable tie mount
12	17	UV stabilized 8" cable ties
13	3	Screw mount cable tie mount
14	10	Adhesive cable tie mount
15	1	Grommet for 1/2" hole
16*	6-10 ft	UV stabilized cable loom*

*Power harness and loom packaged separately.

HALO CONNECT KITS

The Halo Connect Kits include everything necessary to install on a vehicle, except the power harness and cable loom.

Part Number	Description
HC-27XXB	Halo Connect, (XX Vehicle Configuration), GW-20, SE-7

VEHICLE CONFIGURATIONS

STAND ALONE POWER UNITS

Tandem Axle,
Dual Tire
Power Units

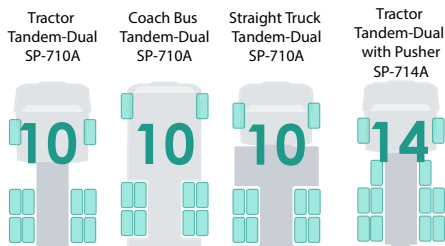

Single Axle,
Dual Tire
Power Units

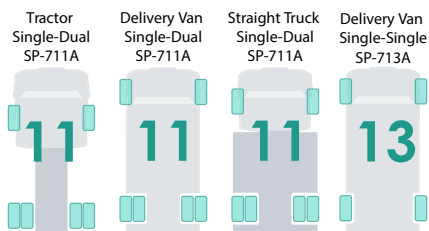

Tandem Axle,
Wide-base Tire
Power Units



MARRIED TRACTOR TRAILERS

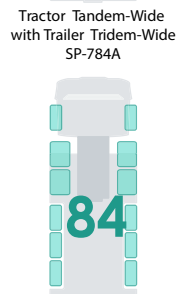
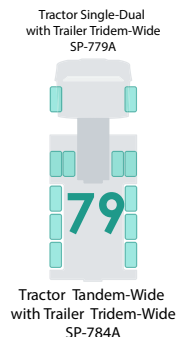
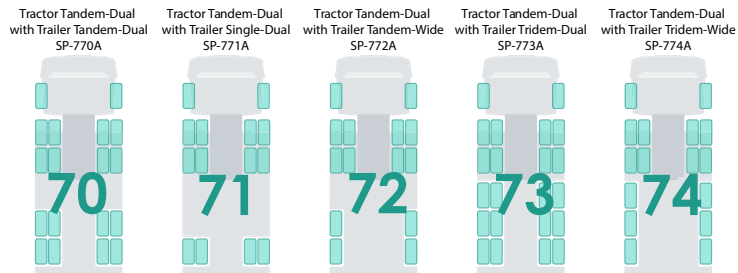

TOOLS AND HARDWARE

Part Number	Description	Application
TK-104SMA	4 in-lb SMA torque wrench	Required to tighten SMA Connectors
HK-100LM	Split loom, 100 ft	Protects the exterior routed cables

HALO CONNECT

POWER HARNESSES

The preferred power source for Halo Connect is the plug and play RP1226 connector found in most new vehicles. Aperia offers a variety of high quality power harness options designed to provide a convenient power connection.

Part Number	Description	Application
CB-RPS16A	RP1226, Splitter, 16 ft	RP1226 Connector
CB-RPS16A-P1	RP1226, Splitter, 16 ft, Pin 1 Power	RP1226 Connector (PACCAR Vehicles)
CB-DC10A	Ring Terminals, 10 ft	Direct to battery, inverter or other factory power and ground studs
CB-SB16A	Terminated Leads, 10 ft	PACCAR Splice Blocks
CB-BL16A	Blade Connectors, 16 ft	PACCAR spare power harness P92-8916
CB-M216A	Terminated Leads, 10 ft	Freightliner M2 & SD114 power splice
CB-PE16A	PACCAR 16-09171Connector, 16ft	Older model PACCAR trucks, spare power ports.
CB-LT16A	International fuse panel, 16 ft	Add circuit to International tractor fuse panel.
CB-LPFT16A	Low Profile Mini fuse add-a-fuse, 16 ft	Fuse panel, add-a-fuse
CB-FT10A	Mini fuse add-a-fuse, 10 ft	Fuse panel, add-a-fuse

TPMS SENSORS

Halo Connect TPMS sensors are externally mounted onto a schrader valve stem. They are offered as kits for three specific vehicle tire configurations or in kits of one or five spare “wildcard” sensors. The vehicle specific sensor packs contain sensors that are marked with tire position, sensor serial number, and sensor model number. The “wildcard” sensors do not have tire position marked on them and can be used to replace a sensor on any tire.

To ensure you select the correct sensor model check the component compatibility chart and the gateway model number in the vehicle. The gateway model number can be found on the Gateway ID label, typically on the door or in the door jamb.

Part Number*	Description	
SP-#10A	Sensor Pack, Tractor, Tandem Axle, Dual Tire, SE-#	10 sensors
SP-#11A	Sensor Pack, Tractor, Single Axle, Dual Tire, SE-#	6 sensors
SP-#12A	Sensor Pack, Tractor, Tandem Axle, Wide-base Tire, SE-#	6 sensors
SP-#01A*	Spare “Wildcard” Sensors, Single Sensor, SE-#	1 sensor
SP-#05A*	Spare “Wildcard” Sensors, 5-Pack, SE-#	5 sensors

= 5, 6, or 7 depending on sensor model.

TPMS SENSOR MODELS

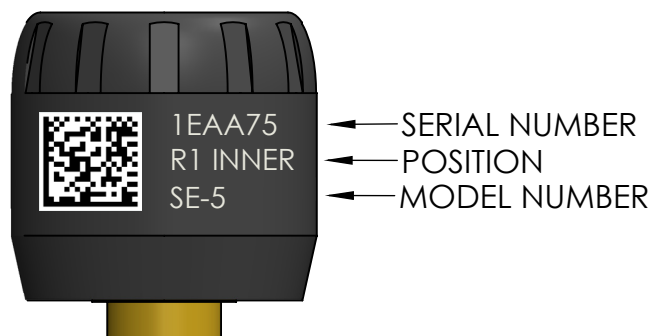

MODEL # SE-5

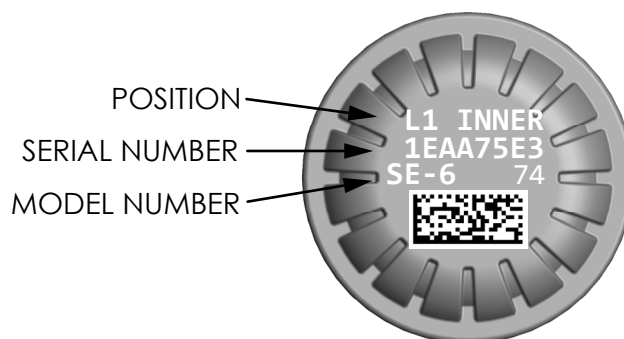

MODEL # SE-6

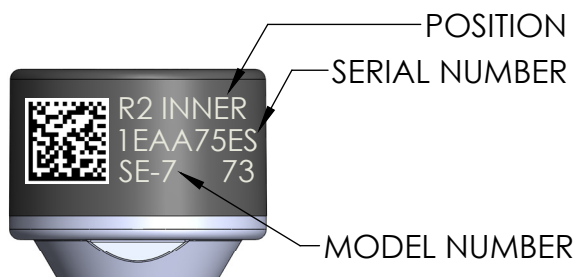

MODEL # SE-7

REPLACEMENT COMPONENTS

ANTENNAS

Part Number	Description
CB-GPS16B	Replacement, GPS Antenna, 16 ft
CB-TPMS20A	Replacement, TPMS Cable/Antenna, 20 ft
CB-LTE6A	Replacement, Cellular Antenna, 6 inch

GATEWAYS

Part Number	Description
GW-10	Replacement, Gateway, Compatible with SE-5 Sensors
GW-20	Replacement, Gateway, Compatible with SE-6/SE-7 Sensor

HARDWARE

Part Number	Description	
HK-100HC	Gateway mounting and cable routing/ protection hardware kit	Replacements for items 9-15 on pg. 10
HK-100LM	Split loom, 100 ft	Protects the exterior routed cables
HK-15LM	Split loom, 15 ft	Protects the exterior routed cables
BR-TPMS	TPMS antenna bracket	Replacement TPMS bracket kit

COMPATIBILITY CHART

There exist three sensor models and two gateway models. To confirm compatibility of replacement parts refer to this chart. The Gateway and Sensors are marked with their model numbers for reference.

Part Number	COMPATIBLE COMPONENTS							
	Gateway Model	SENSOR PACK		ANTENNAS			Hardware Kit	TPMS Bracket
		Sensor Pack	Sensor Model	TPMS	GPS	LTE		
HC-1510B-XX	GW-10	SP-510A	SE-5	CB-TPMS20A	CB-GPS16B	CB-LTE6	FA-100HK	BR-TPMS
HC-1511B-XX	GW-10	SP-511A	SE-5					
HC-1512B-XX	GW-10	SP-512A	SE-5					
HC-2610B-XX	GW-20	SP-610A	SE-6					
HC-2611B-XX	GW-20	SP-611A	SE-6					
HC-2612B-XX	GW-20	SP-612A	SE-6					
HC-2710B-XX	GW-20	SP-710A	SE-7					
HC-2711B-XX	GW-20	SP-711A	SE-7					
HC-2712B-XX	GW-20	SP-712A	SE-7					

HALO TIRE INFLATOR™ - COMPATIBLE WITH 1ST GENERATION BRACKETS

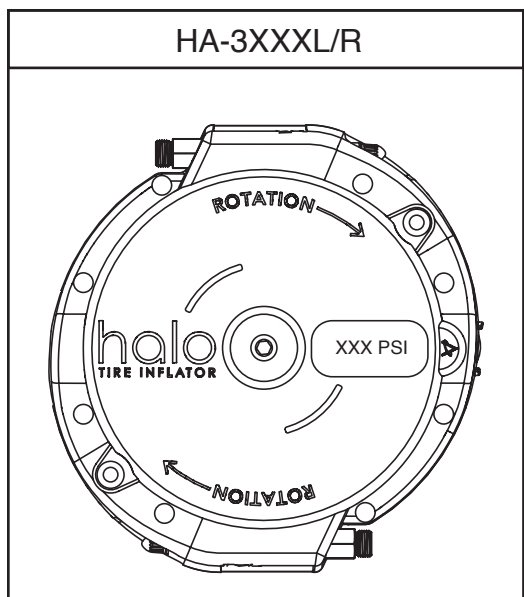

Part Number		Target Tire Pressure
Left	Right	
HA-3080L	HA-3080R	80 PSI
HA-3085L	HA-3085R	85 PSI
HA-3090L	HA-3090R	90 PSI
HA-3095L	HA-3095R	95 PSI
HA-3100L	HA-3100R	100 PSI
HA-3105L	HA-3105R	105 PSI
HA-3110L	HA-3110R	110 PSI
HA-3115L	HA-3115R	115 PSI
HA-3120L	HA-3120R	120 PSI



halo
TIRE INFLATOR

The first & only
full vehicle solution



HALO W/ 1ST GEN. BRACKETS

HALO SYSTEM COMPONENTS - FOR 1ST GENERATION BRACKETS

One component or kit from each category is required for a complete wheel-end installation.

1

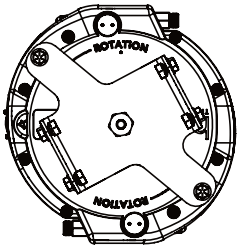

Halo Tire Inflator™

2

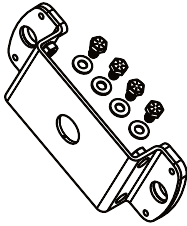

Tractor Bracket Kit

OR

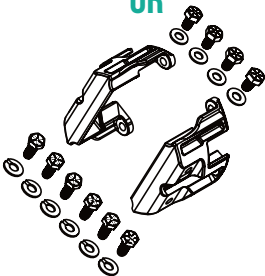

Trailer Bracket Kit

3

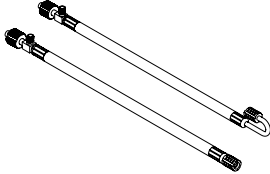

Hoses For Dual Tires

OR

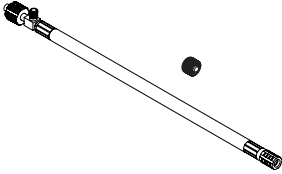

Hose for Wide-base

1ST GENERATION BRACKET KITS

Part Number	Tractor/Trailer	Description	Hub Stud/ Bolt Diameter	Stud/Bolt Circle Dia.	# of Studs/ Bolts
BR-8758A	Tractor	Drive Axle	5/8 in.	7 in.	8
BR-8758TB	Tractor	Tall for 6x2 tag/push	5/8 in.	7 in.	8
BR-8734B	Tractor	Drive Axle	3/4 in.	7 in.	8
BR-8758AC	Tractor	Drive Axle	5/8 in.	7 in.	8
BR-4009A**	Trailer/Lift Axle	N-type Spindle	5/16 in.	5 1/2 in.	6
BR-4195A**	Trailer/Lift Axle	P-type Spindle	5/16 in.	6 3/4 in.	6

**Trailer/lift axle brackets ship with replacement hubcap bolts.(FA-200A)

BR-87XXA

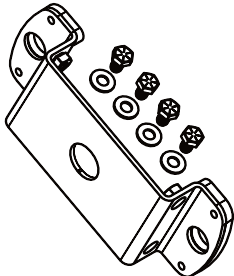

BR-4009A

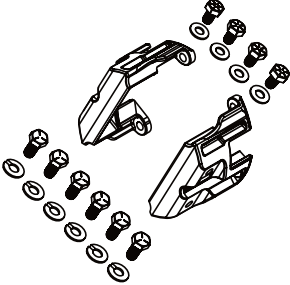

BR-4195A

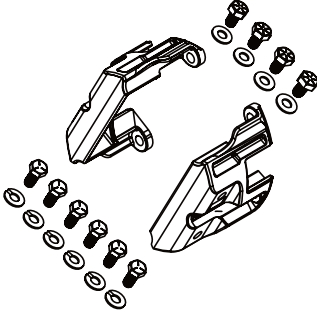

FLOWBELOW PARTS

The Halo is compatible with FlowBelow wheel covers on trucks with either dual or wide-base tires. The Aperia sales team can help determine which parts you need to ensure a proper fit with your vehicle.

Part Number	Description
AC-200FB	FlowBelow to Halo Adaptor
AC-215FB	FlowBelow Standoff Kit, 1.5 in.
AC-220FB	FlowBelow Standoff Kit, 2.0 in.
BR-8758AC	Tractor, Accessory Bracket
FA-101FB	Fastener Kit, FlowBelow Mounting Nuts

TAMPER RESISTANT KITS

The Tamper-Resistant Fastener Kit (FA-100TR) is designed and engineered to deter theft attempts. The tool (TK-100TR) is shipped separately in a labeled bag and should be stored in the vehicle after installation.

Part Number	Description
FA-100TR	Fastener Kit, Tamper-Resistant, 1 Vehicle (4 Halos), Security Torx
TK-100TR	Tool Kit, Tamper-resistant Torx

SERVICE KITS & TOOL KITS

Service kits include the parts and consumable items required to return damaged Halos to working order. Tool kits contain tools that work best with the Halo.

Part Number	Description
TK-100HI	Tool Kit, Hose Install
SK-101AD	Service Kit, Replacement, Halo Adaptor Plate, 1.0
SK-200AD	Service Kit, Replacement, Halo Adaptor Plate, 2.0
SK-200HF	Service Kit, Replacement, Round Hose Fittings
TK-200HF	Tool Kit, Round Hose Fittings

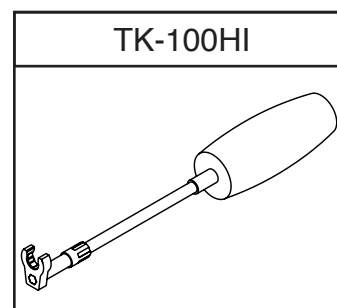

Speed up install and removal. Reach the hose at the valve stem.

HALO W/ 1ST GEN. BRACKETS

FASTENER REPLACEMENT KITS

Aperia’s fasteners have been designed to ensure proper strength and corrosion resistance. Be sure to replace any lost or damaged fasteners with fasteners provided by Aperia.

Part Number	Description	Included with
FA-100BR	Fastener Kit, Replacement, Halo Adaptor Plate to Bracket, 1 Halo	All Brackets
FA-200A	Fastener Kit, Replacement, Trailer Bracket, Hubcap Bolts, 6 bolts	Trailer Brackets
FA-100AD	Fastener Kit, Replacement, Halo Adaptor Plate, 1.0	SK-101AD
FA-200AD	Fastener Kit, Replacement, Halo Adaptor Plate, 2.0	SK-200AD
FA-100FB	Fastener Kit, Replacement, FlowBelow Adaptor	AC-200FB
FA-100CH	Fastener Kit, Chrome Cover	AC-200CH

ACCESSORIES/REPLACEMENT PARTS

Part Number	Description
AC-200CH	Halo Chrome Cover
AC-100HS	Conversion Cap, Dual Tires to Wide-base Tires
AC-100HR	Hose Retention Kit

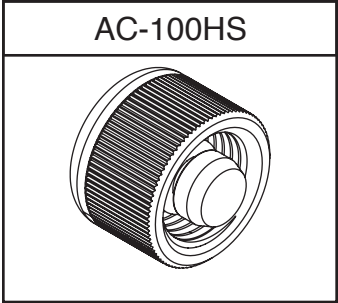

INSTRUCTIONS & USER MANUALS

Part Number	Description
IN-100UM	User Manual, Halo Tire Inflator
IN-100RL	Roadside Service Instruction Label

Find more product documentation on the Aperia literature webpage.
www.aperiatech.com/literature



@aperiatech



@aperia_technologies

Aperia Technologies, Inc.

3160 Corporate Place
Hayward, CA 94545

Phone: (650) 741-3231

Fax: (415) 524-2449

www.aperiatech.com



© 2023 Aperia Technologies, Inc.
90-00004917 Rev. R10