

halo

TIRE INFLATOR

HALO - FLOWBELOW STANDOFF KIT INSTALLATION INSTRUCTIONS

PARTS

1 x Accessory
hub bracket

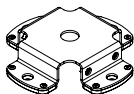

1 x FlowBelow
standoff kit

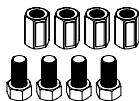

REQUIRED TOOLS

Torque wrench
capable of 50 ft-lb



15/16" socket



For further assistance, contact technical support at 1 (650) 741-3231.



INSTRUCTIONS

The instructions below outline the installation of the Halo - FlowBelow Standoff kit.

1. Finger tighten 2 of the standoffs to the mounting bracket. Install the standoffs on the sides of the bracket with the pair of mounting holes.

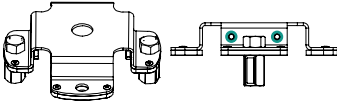

2. Follow the instructions in the Halo User Manual to determine the correct hose lengths and to select the proper hub studs for mounting.

3. Remove the standoffs from the bracket.

4. If there is less than 3/8" (9.5mm) of thread showing, replace the nut with a shorter nut.

If there is more than 1" (25.4mm) of thread showing, add a washer under each standoff until there is less than 1" (25.4mm) of thread above the nut.

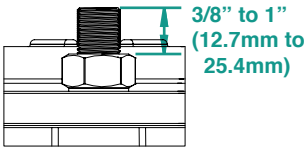

5. Install the standoffs to the 4 studs identified through the hose fitting process in step 2.

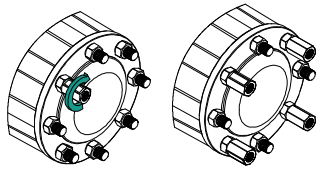

Torque: 50 ft-lb (67.8 N-m)

6. Align the bracket onto the 4 standoffs, ensuring one of the sides with the Halo mounting holes is aligned to the stud you found in step 2.

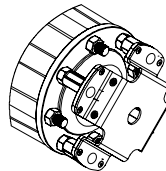

7. Install the 4 bolts onto the standoffs and tighten them.

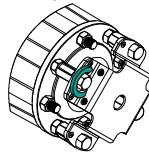

Torque: 50 ft-lb (67.8 N-m)

8. Follow the remaining installation instructions in the Halo User Manual.